



## ARCHISHAPE® Tube Ultra Slim RGB+W

ARCHISHAPE® Tube Ultra Slim is an IP66-rated slim LED tube for any wall or façade media lighting. Available in 300/500/1000mm lengths, the simple but robust construction allows up to maximum 12 meters of tubes to be daisy chained on a single power supply unit.



### Product Specifications

	300mm	500mm	1000mm
<b>Light Source</b>	9RGB + 9White	15RGB + 15White	30RGB + 30White
<b>Color Range</b>	16.7 Million additive RGB colors; White CCT 5000K		
<b>Beam Angle</b>	100° (Direct view)		
<b>Luminous Flux</b>	156 lm	266 lm	528 lm
<b>Efficacy</b>	44 lm/W		
<b>LED Pitch</b>	16.6mm		
<b>Pixel Configuration</b>	3 RGB LEDs + 3 White LEDs per pixel		
<b>Number of Pixel</b>	3 pixels	5 pixels	10 pixels
<b>Housing</b>	Aluminium housing		
<b>Adjustment Options</b>	Fixed, non-adjustable		
<b>Dimensions (W x H)</b>	15.5 x 17.5mm, 35 x 37.6mm (mounting bracket included)		
<b>Dimensions (L)</b>	300mm	500mm	1000mm
<b>Weight</b>	0.18kg	0.3kg	0.5kg
<b>Safety Approval</b>	CE		
<b>Operating Temperature</b>	-25°C to +50°C / -13°F to +122°F		
<b>Storage Temperature</b>	-40°C to +70°C / -40°F to +158°F		
<b>Environment</b>	Outdoor, IP66		
<b>Humidity</b>	10-90%, non-condensing		

### Electrical Specifications

<b>Operating Voltage</b>	48V DC		
<b>Power Consumption</b>	3.6W	6.2W	12W

### System Specifications

<b>Control</b>	DMX512
<b>Power Supply</b>	LED Engine 240W 48V Outdoor
<b>Addressing Options</b>	Auto-addressing per daisy-chain

**LED CHARACTERISTICS** Because LEDs are semiconductor devices, their performances are subject to inherent variability commonly found in semiconductor industry. To improve consistency in performance across the same product, LED manufacturers "sort" LEDs into bins according to different preset parameters, such as forward driving voltage, illumination, etc. Whereas binning is a sorting function, it is not a correction process. Inherent variability in the manufacturing process results always in different binning distributions according to different production lots. Traxon uses automatically binned LEDs on its products, thereby minimizing output variations within the model range.

As with all electronic devices, LED output degrades over time – a term called lumen depreciation. This also explains why it is nearly impossible to expect photometric performances of two LED products with different service life spans to be the same. The rate of LED degrade is a complicate function of many factors such as operating efficiency, duration of continuous operation, and more significantly, environmental conditions (ambient temperature for example). If allowed working under optimal operating temperature range and with good ventilation, LED devices enjoy long service lives over conventional light sources. When using/installing LED devices, care should be taken to ensure that the devices will operate within the operating conditions specified in respective product literature.

[www.traxontechnologies.com](http://www.traxontechnologies.com)

©2020 TRAXON TECHNOLOGIES - AN OSRAM BUSINESS. ALL RIGHTS RESERVED. TRAXON™, TX CONNECT®, ARE TRADEMARKS OF TRAXON TECHNOLOGIES. U.S. PATENTS, E.U. PATENTS, JAPAN PATENTS, OTHER PATENTS PENDING. SPECIFICATIONS ARE SUBJECT TO CHANGE WITHOUT NOTICE.

### Candela Distribution

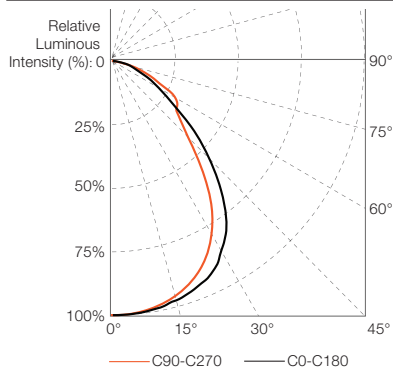

### Light Output

Color	Luminous Flux (lm)
<b>300</b>	
White 5000K (RGBW full-on)	156.2 lm
RGB	59.4 lm
Red	17.0 lm
Green	31.5 lm
Blue	11.0 lm
White 5000K (RGB off)	96.8 lm
<b>500</b>	
White 5000K (RGBW full-on)	265.9 lm
RGB	101.1 lm
Red	28.9 lm
Green	53.6 lm
Blue	18.7 lm
White 5000K (RGB off)	164.8 lm
<b>1000</b>	
White 5000K (RGBW full-on)	528.1 lm
RGB	200.9 lm
Red	57.3 lm
Green	106.4 lm
Blue	37.2 lm
White 5000K (RGB off)	327.2 lm

### Illuminance at a Distance

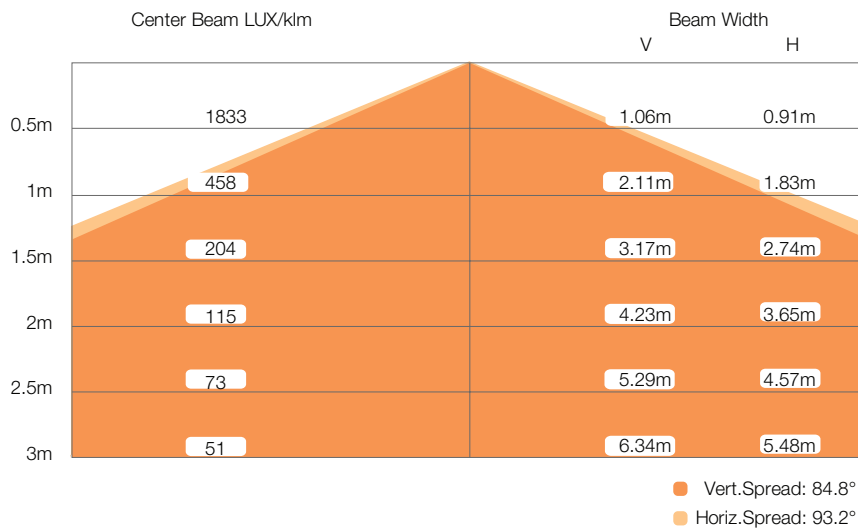

Dimensions (Unit: mm)

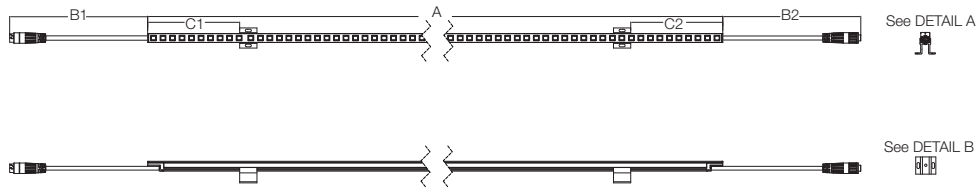

Tube length A	Cable length B1	Cable length B2	Bracket position C1	Bracket position C2
1000	200	160	160	160
500	200	160	160	160
300	200	160	80	120

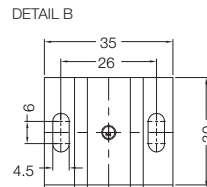
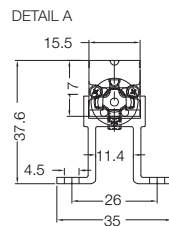

Accessories Dimensions (Unit: mm)

End Cap with 120 Ohm

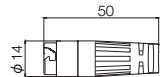

Interconnection Cable

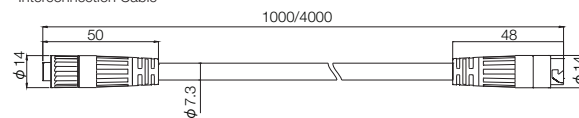

Starter Cable

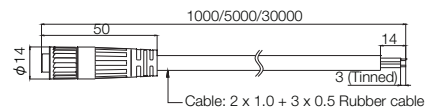

LED Pattern

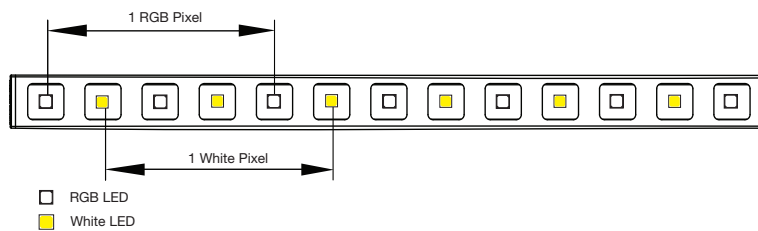

[www.traxontechnologies.com](http://www.traxontechnologies.com)

©2020 TRAXON TECHNOLOGIES - AN OSRAM BUSINESS. ALL RIGHTS RESERVED. TRAXON™, TX CONNECT®, ARE TRADEMARKS OF TRAXON TECHNOLOGIES. U.S. PATENTS, E.U. PATENTS, JAPAN PATENTS, OTHER PATENTS PENDING. SPECIFICATIONS ARE SUBJECT TO CHANGE WITHOUT NOTICE.

### Mounting

Cable connection

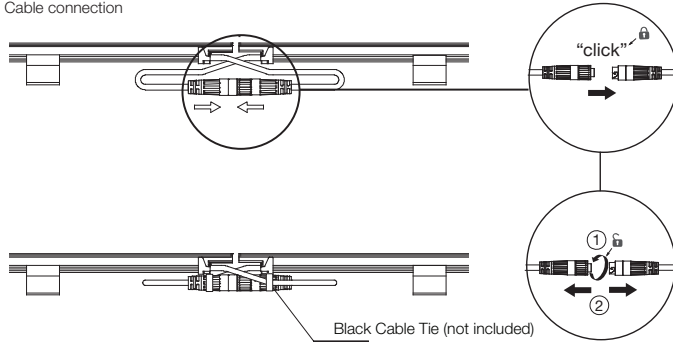

If you do not hear "click", rotate the spring loaded lock nut manually (in opposite direction to loosening) to ensure that the connectors are properly mated and tightened.

### Bracket Mounting

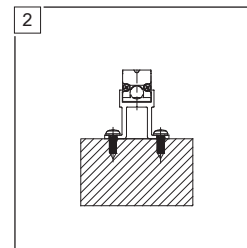
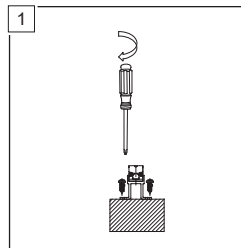
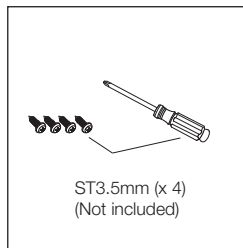

### Tube-to-Tube Clearance

To maintain consistent LED pitch and to allow for thermal expansion for Tubes.

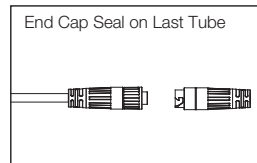
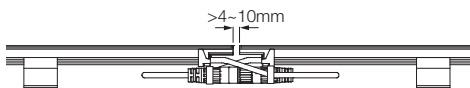

Connector Pin Assignment

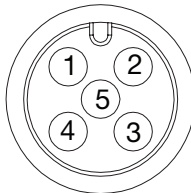

Wire#	Description	Color
1	Signal ground	Yellow
2	DC48V+	Red
3	DMX-	Green
4	DMX+	Blue
5	DC48V-	Black

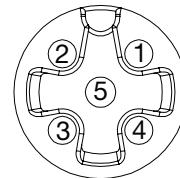

Daisy chain of 12m tubes

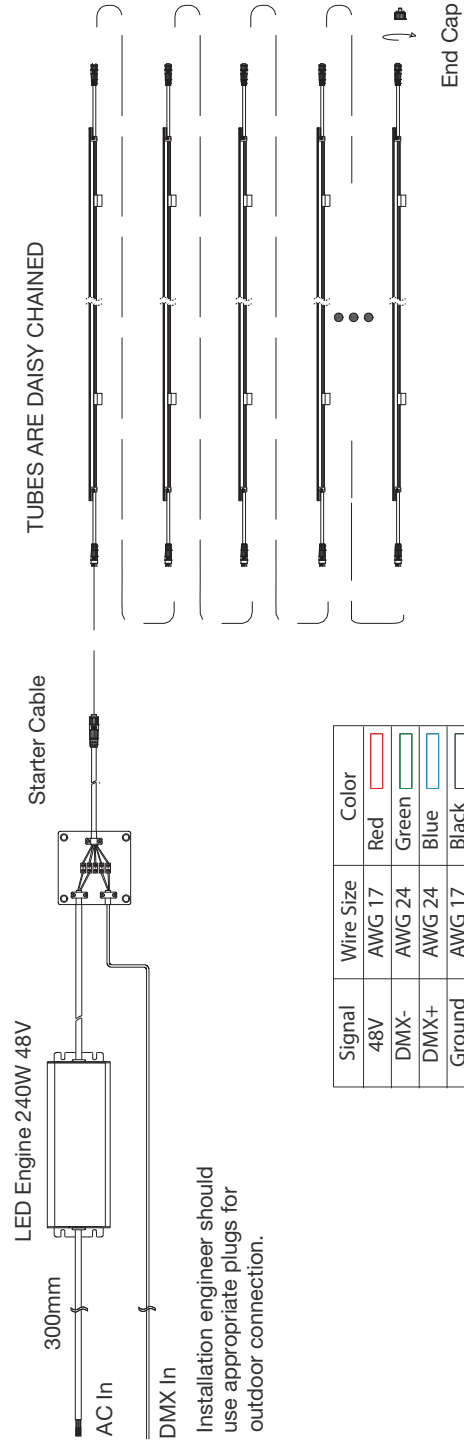

This wiring diagram shows only typical connections. Actual wiring depends on LED Tube configuration and installation. Actual no. vary according to cable lengths and signal source. Please consult your local Traxon office for aid.



## ARCHISHAPE® Tube Ultra Slim RGB+W

Ordering

### Fixtures

Model No.	Description	Item Code
TU.AS.3110100	AS TUBE RGBW 1000 10PXL 48V DV	AM381760055
TU.AS.2105100	AS TUBE RGBW 500 5PXL 48V DV	AM381800055
TU.AS.1103100	AS TUBE RGBW 300 3PXL 48V DV	AM381820055

### TX Connect

Model No.	Description	Item Code
TU.AC.1100100	AS TUBE STARTER CABLE 5-WIRE, 1M	AM382010055
TU.AC.1100200	AS TUBE STARTER CABLE 5-WIRE, 5M	AM382020055
TU.AC.1100300	AS TUBE STARTER CABLE 5-WIRE, 30M	AM382030055
TU.AC.1100600	AS INTERCONNECTION CABLE, 5-WIRE, 1M	AM382060055
TU.AC.1100700	AS INTERCONNECTION CABLE, 5-WIRE, 4M	AM382070055
TU.AC.1100400	AS TUBE END CAP WITH 120Ω TERMINATOR	AM382040055

### TX Control

Model No.	Description	Item Code
N/A	LED Engine 240W 48V Outdoor	AM089330055